

Reeves SWD and Solids Injection Facility*

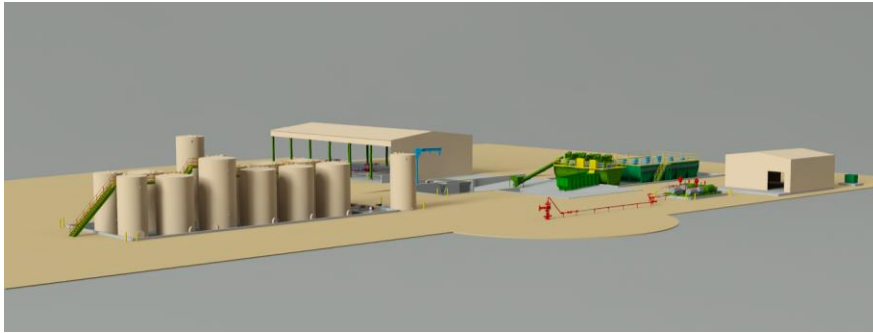

New Disposal Solution for the Local Energy Industry: Reeves SWD and Solids Injection Facility

Reeves SWD and Solids Injection Facility (Reeves) provides safe and convenient disposal services for managing solid and liquid wastes. Save time, cut transportation and reduce risk. Bring your oilfield waste to Reeves.

Benefits

- **Convenient:** Accommodates oilfield wastes, solids and liquids, at a single location to save time and transportation
- **Environmentally-sound:** Facility has a small footprint and uses proven technology and processes to minimize risk (storage, exposure pathways)
- **Efficient:** Eliminates solidification costs and reduces cost of transporting drilling wastes to a disposal facility

Our safe and efficient process creates a slurry from solid and liquid oilfield wastes. It injects the slurry into naturally occurring hydraulic fractures or those created during the injection process. Disposal zones are selected based on isolation from freshwater sources and confining barriers which prevent waste migration and fracture propagation beyond the disposal horizon. We use advanced analytical and empirical techniques to continually monitor the injection to ensure integrity of the injector and nearby wells and to confirm fracture containment at all times.

**This facility is owned and operated by Waste Management Energy Services of Texas, LLC using Advantek subsurface monitoring technology.*

Reeves County Solids and Liquids Injection Facility

616 E Interstate 10 Service Rd
Balmorhea, TX 79718
GPS Coordinates: 30.976889-
103.558778

Accepts All Oilfield Waste
Drill Cuttings: Oil Base, Water Base
Drilling Mud: Oil Base, Water Base
Produced Water
Flow Back Water
Acid Water
Pit Water
Tank and Pit Sludge

Contact Us

Learn how you can improve efficiency and save money by bringing your oilfield waste to Reeves.

Jason T. Chan
Director of Operations
jchan2@wm.com
303-598-1790

Johannes Kohn
Area Manager
jkohn1@wm.com
701-609-3650

Travis Carpenter
Sales
tcarpen6@wm.com
432-557-7333

Monitoring and Controls

We constantly evaluate surface and subsurface risks through real-time surveillance to ensure that the surface pressures and subsurface behaviors are within bounds. Field operators and subsurface engineers collaborate to monitor and control the well. Cap rock above the injection zone acts as stiffness, stress and/or permeability barriers to fracture growth.

By gathering highly-granular data during and after each injection event, we can conduct sophisticated post-injection analyses (fall-off tests) which measure formation/reservoir properties, fracture geometry, and stress contrast between injection and confining zones. We believe in strong monitoring and controls to maximize safety.

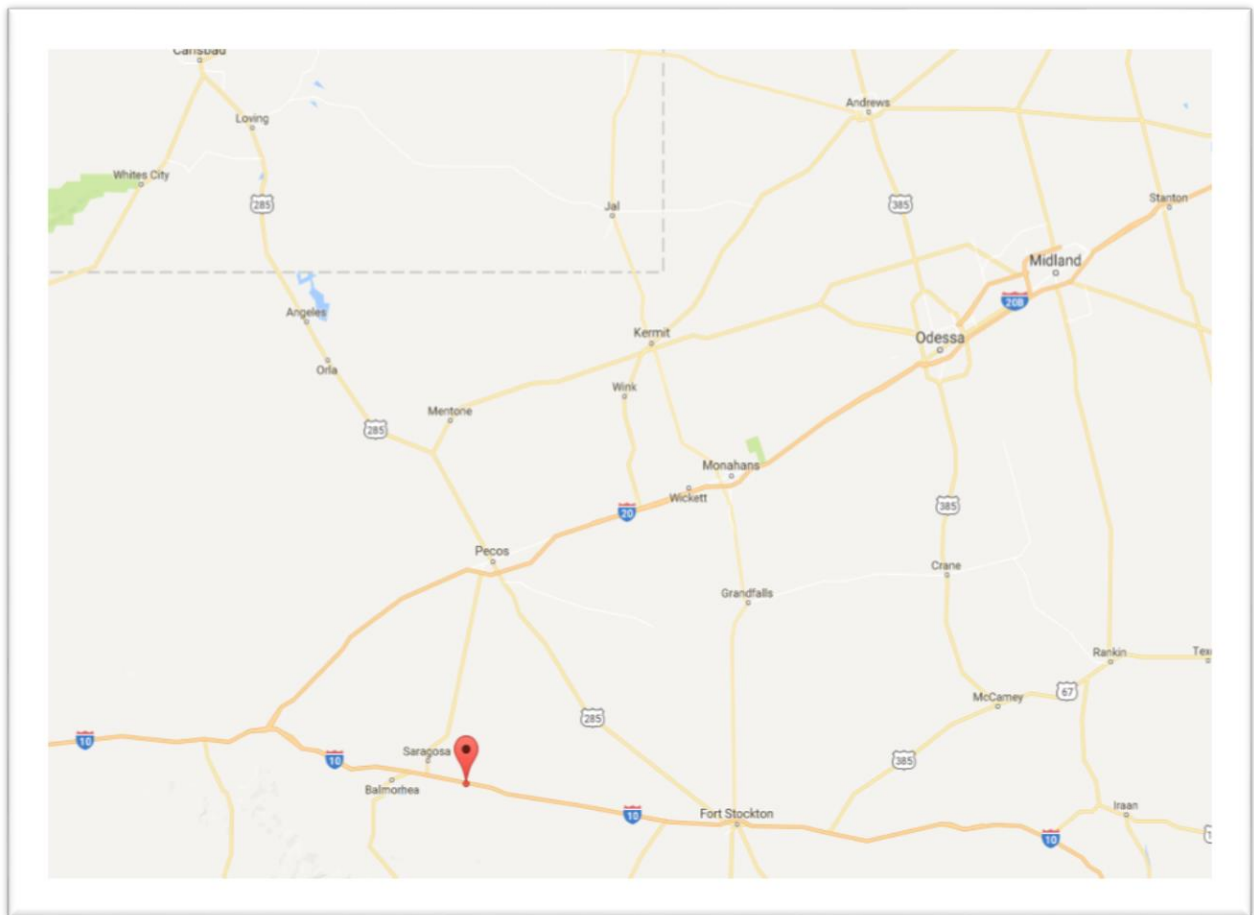

Latitude: 30.976889, Longitude: -103.558778
(Google Map 30.976889-103.558778)

**This facility is owned and operated by Waste Management Energy Services of Texas, LLC using Advantek subsurface monitoring technology.*